

Information Prior to Arriving

General Information

Meeting Location & Contact Information

Hilton Singapore Orchard

333 Orchard Road, Singapore 238867

T: (65) 6737 4411

F: (65) 6732 2361

E: hiltonsingaporeorchard.info@hilton.com

Hilton Singapore Orchard is easily accessible. The nearest MRT station is *Somerset*. The hotel is accessible via hotel limousines, taxis, airport shuttle buses, trains and public buses from and to the Airport.

By Taxi

Metered taxis to the hotel are readily available at the Arrival Halls of Singapore Changi Airport. Travelling time from the Airport to the hotel is around 30 minutes. Taxi fare from the Airport is approximately \$25.00 by meter.

By MRT

Train services are available at the Airport train station located at Terminal 2 and Terminal 3. Transfer to the westbound train at *Tanah Merah* train station to alight at *Somerset* train station. The hotel is a 5-minute walk from the station. MRT fare is approximately \$2.00 per person. More information can be found at:

<https://www.visitsingapore.com/travel-guide-tips/getting-around/>



Electricity and Plug

Electricity in Singapore is 230 Volts, alternating at 50 cycles per second. If you travel to Singapore with a device that does not accept 230 Volts at 50 Hertz, you will need a voltage converter. Outlets in Singapore generally accept one type of plug, having two parallel flat pins with ground pin. If your appliances plug has a different shape, you may need a plug adapter.

Singapore plug adapters: the grounded plug adapter WA-7 and the ungrounded plug adapter #5. These are the recommended wall outlet plug adapters for Singapore.

Useful Contact Information

Emergency

Police	999	Flight Info	800 542 4422
Fire Brigade	995	Tourist Hotline	800 736 2000
Ambulance	995	Directory	100

Dial a Cab

General Hotline	(65) 6342 5222	TIBS & SMRT	(65) 6555 8888
Comfort & City	(65) 6552 1111	Premier	(65) 6363 6888
Trans-Cab	(65) 6555 3333	Prime Taxi	(65) 6778 0808

Credit Cards

AMEX	1800 295 0500	Diners Club	6416 0900
JCB	(65) 6734 0096	Visa	800 448 1250
Master	800 110 0113		

Conference Registration

1 - 3 August 2022 (Monday to Wednesday) 0800 am - 0900 am at Grand Ballroom 1 at Level 6 Orchard Wing of the hotel. Participants may also visit our registration booth throughout the 3 days of conference.

All participants are expected to register and collect their conference artcard and lanyard prior to attending the conference. The artcard will be provided upon registration and will serve as the official pass to sessions, coffee breaks, lunches, and other official functions.

Conference Dinner

(Strictly for non-student paying participants only)

Date 1 August 2022 (Monday)

Time 0730 pm - 1000 pm

Venue Hilton Singapore Orchard, Grand Ballroom 3 at Level 6

Daily Tea Reception & Lunch Buffet

- Morning tea on 1 and 2 August 2022 will be served at level 6, Grand Ballroom 3.
- Lunch will be served daily at Grand Ballroom 3.
- Afternoon tea for 1 and 2 August will be served at Level 8 foyer, just outside the 5 breakout rooms.
- Afternoon Tea on 3 Aug: Reception with Journal Editors will be held at Grand Ballroom 1, with the food being at Grand Ballroom 3 (just next door).

Conference Rooms and Floor Plans

The opening plenary and all plenary sessions will be held at the Grand Ballroom 1 which are located at Level 6 of the hotel. All other special/parallel sessions will be held at Breakout Rooms: Lilac, Frangipani, Camellia, Jasmine, Amaryllis at Level 8. Please see below blueprints of the room(s).

Grand Ballrooms at Level 6

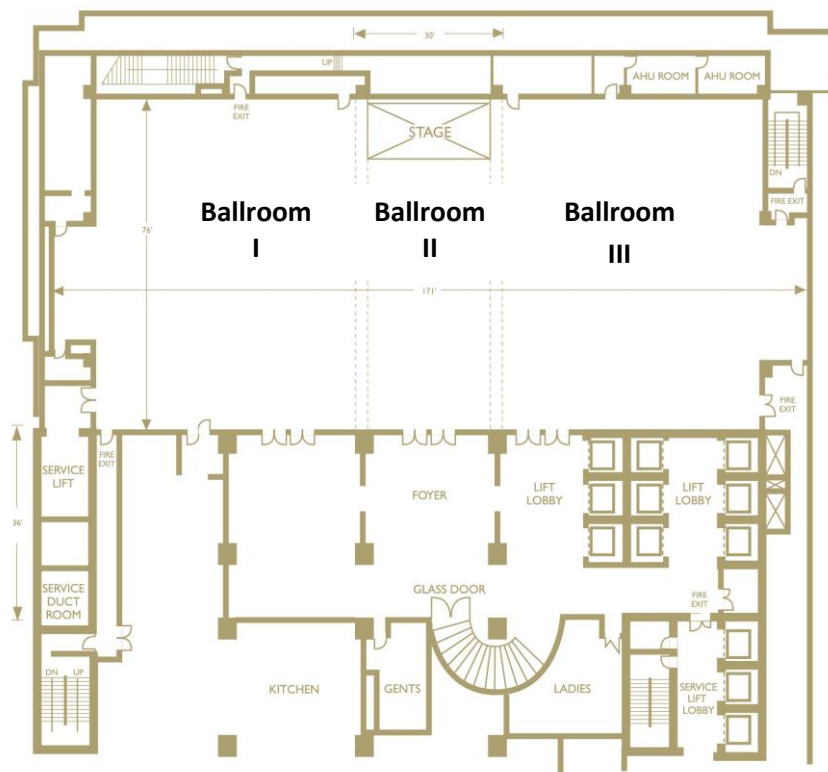

Breakout Rooms at Level 8

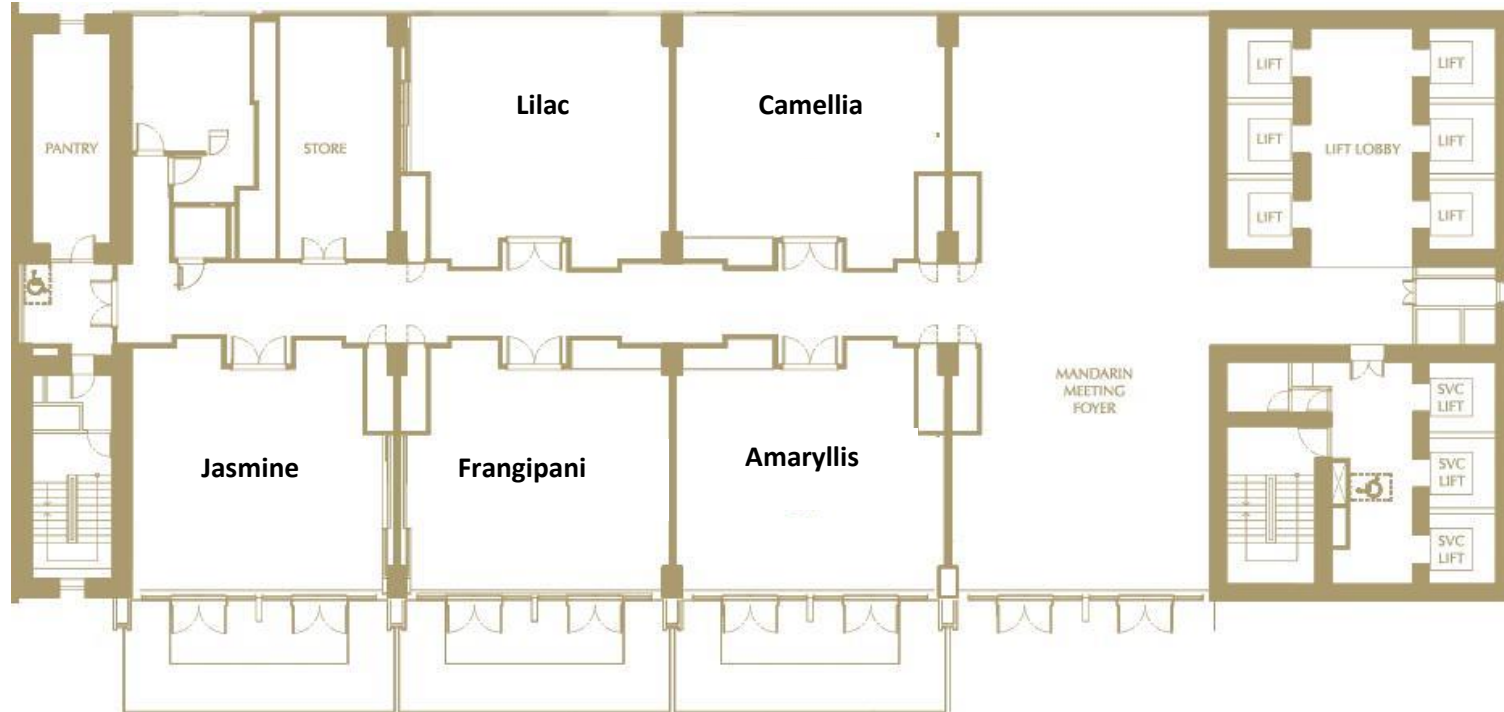

Uploading of Presentation – Service Station and Hours

Paper presenters are to upload PowerPoint slides to the laptops provided in the breakout rooms 10 minutes before their scheduled presentations. Laptops are installed with Windows OS and able to accept USB thumb drives.

Information & Assistance

Visit the Help Desk located outside Grand Ballroom 1 foyer at Level 6.

Personal Message Board

If you wish to get in touch with fellow delegates, please leave your message with our registration desk at the foyer outside Grand Ballroom 1.

Internet Access

Wireless internet access within the hotel area is chargeable. Please contact the Hotel Business Centre.

Travel & Tour

Tour information is available at the hotel reception.